

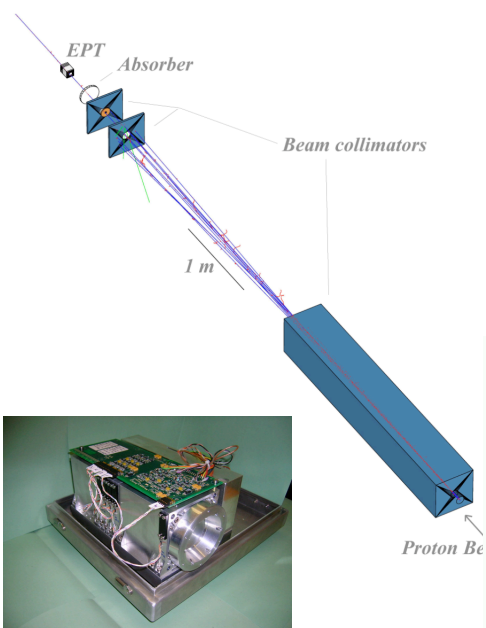

EPT Configuration and GEANT4 Simulations Tools

M. Cyamukungu
J. Cabrera

Energetic Particle Telescope

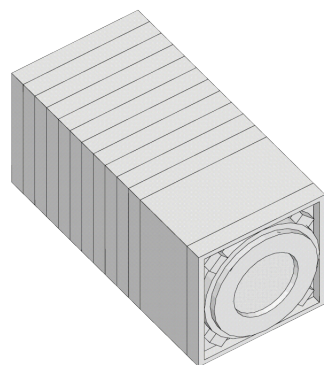

Particle identification	Mechanical and electrical features
Electrons 200 keV - 10 MeV	Aperture diameter 35 mm
Protons 4 MeV - 300 MeV	FOV 90° max
Alpha particles 16 MeV - 1 GeV	Geometrical Factor Energy dependent (TBD by GEANT4)
Timing features	Mass < 5kg
Resolution Adjustable between 0.1 and 10 seconds, with a nominal integration period of 1 second	Dimensions 110 x 110 x 200 mm ³
Peak flux 10 ⁷ cm ⁻² sr ⁻¹ s ⁻¹	Power < 6W

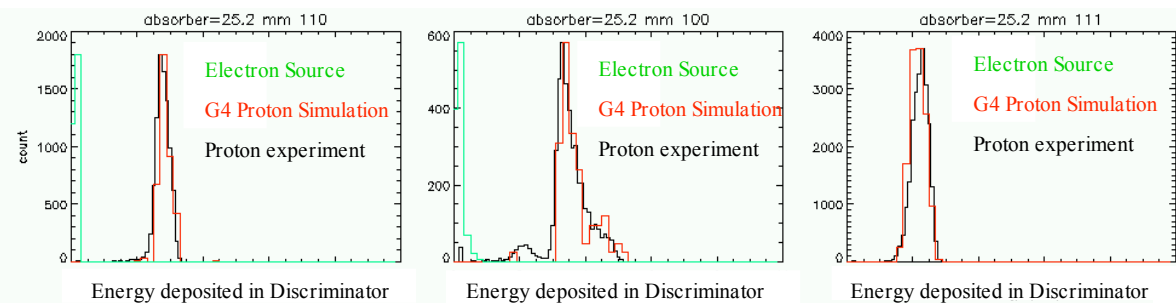



The EPT Configuration and GEANT4 Simulation tools were developed to make (online) configuring of EPT-like instruments as easy as using MULASSIS.

However, it was not possible to present these tools without infringing No Disclosure Agreements applied within the EPT consortium. We apologize for any inconvenience!

Typical EPT characteristics derived from the use of the developed tools are presented on the sheet available at the reception desk.

Thanks for understanding!